

Qvintip® Instructions for Use – Self-sampling for HPV analysis

Qvintip

Qvintip is a self-sampler with a detachable tip, that allows you to collect a vaginal fluid sample yourself. The sample is forwarded to a laboratory for HPV analysis.

Why should I take an HPV test?

A persistent infection with high-risk HPV (human papillomavirus) can over time lead to cell changes which may develop into cervical cancer. Your sample will be analysed for the presence of high-risk HPV.

Important notes

- Qvintip should be handled with care and only according to these instructions.
- The white tip may not be removed or bent before sampling.
- Do not use during menstruation.
- For single use only.
- It is advisable to refrain from intercourse and the use of vaginal creams, gels and tablets for 48 hours prior to sampling.
- Sampling may be performed during the first three months of pregnancy.
- Keep the sampler out of reach for children.

Material

Materials provided: Qvintip sampler

Materials required but not provided: Test tube with cap

Self-sampling instructions

Before use, check that the sampler is intact with the white tip attached to the blue handle. Sampling can be done in a standing or lying position. Prepare for sampling by washing your hands and removing the cap from the test tube. Put tube and cap aside.

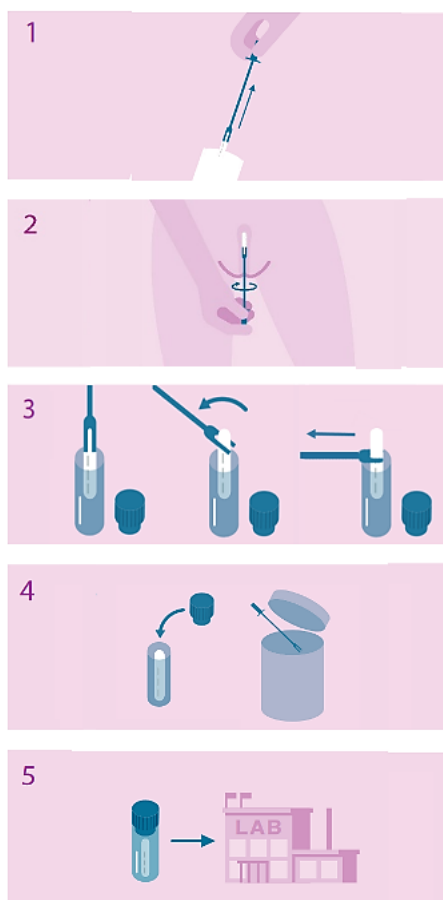

1. Open the packaging and remove Qvintip sampler by holding the blue handle. Keep the sampler straight. Be careful not to touch anything with the white tip.
2. Slide the sampler gently into your vagina until you feel that it has reached the bottom (about 10 cm).
 - a) Turn the sampler five full rotations.
 - b) Remove the sampler (keeping it straight).
3. Hold the sampler in one hand and the tube in the other. Place the white tip of the sampler into the tube as far down as the figure shows. Bend the sampler until the blue part touches the tube. Slowly pull the handle away from the tube so that the white tip breaks off and falls into the tube.
4. Put the cap on the tube. Dispose the blue handle. The handle is sorted as plastic.
5. The tube containing the white tip should then be transferred to a laboratory for HPV analysis as soon as possible.

Any questions?

Find the answer in the FAQ page on our website, or please send us a message at www.aprovix.com/contact-us.

Thank you for using Qvintip!

Reporting of serious incidents

If any serious incident occurs when using this device, it should be reported to the manufacturer and to the competent authority of the Member State. By reporting serious incidents, you can help provide more information on the safety of this medical device.



Read the instructions before use



Single use only



Expiry date, see packaging



LOT/batch no, see packaging



Made in Sweden

© Copyright 06/2020 Aprovix AB | IFU Article no. 10-002

Aprovix AB, Birger Jarlsgatan 57 C, 113 56 Stockholm, Sweden
info@aprovix.com, www.aprovix.com